



Service Bulletin

File In Section: 07 - Transmission/Transaxle

Bulletin No.: 03-07-30-017

Date: May, 2003



TECHNICAL

Subject: Grind Noise or No Vehicle Movement when Shifting into Drive or Reverse
(Inspect Transaxle, Replace Various Transaxle Components)

Models: 1999-2002 Buick Century, LeSabre, Park Avenue
2002 Buick Rendezvous
1999-2002 Chevrolet Monte Carlo, Venture
2000-2002 Chevrolet Impala
1999-2002 Oldsmobile Intrigue, Silhouette
1999-2002 Pontiac Bonneville, Grand Prix, Montana
2001-2002 Pontiac Aztek
with Transaxle Auto 4-SPD, 4T65-E (RPO MN3)

Condition

Some customers may comment on a grinding noise when shifting into DRIVE or REVERSE or the vehicle will not move in DRIVE or REVERSE.

Correction

Important:

- If the vehicle DOES NOT exhibit a grinding condition but DOES exhibit shifting concerns, refer to Corporate Bulletin #00-07-30-002.
- When servicing the transaxle side cover gasket, refer to Corporate Bulletin #01-07-30-032.
- When servicing the valve body spacer plate and/or gasket, refer to Informational Corporate Bulletin #02-07-30-014.
- When servicing or replacing the transaxle resulting from this condition, the transaxle cooler MUST be flushed. Refer to Informational Corporate Bulletin #02-07-30-052.

Follow the service procedure below for diagnosis and correction of the grinding noise condition.

Important: If metallic debris is found on the transaxle pan magnet, the transaxle must be completely disassembled and cleaned. Failure to properly clean the transaxle case and internal components may lead to additional unnecessary repeat repairs.

1. Remove the transaxle oil pan and inspect the magnet in the bottom of the pan for metal debris. Refer to SI Document ID #414136.
2. Remove the transaxle from the vehicle. Refer to the appropriate SI document.

Important:

- Inspect all the transaxle components for damage or wear. Replace all damaged or worn components. The parts listed below should be sufficient to correct this concern.
- This condition does not normally require replacement or reconditioning of the transaxle completely unless there is extensive damage. Components such as clutches, valve body and torque converters WILL NOT require replacement to correct this condition.

3. Disassemble the transaxle. Refer to the Transmission Overhaul procedure in Unit Repair, SI Document ID #633950.

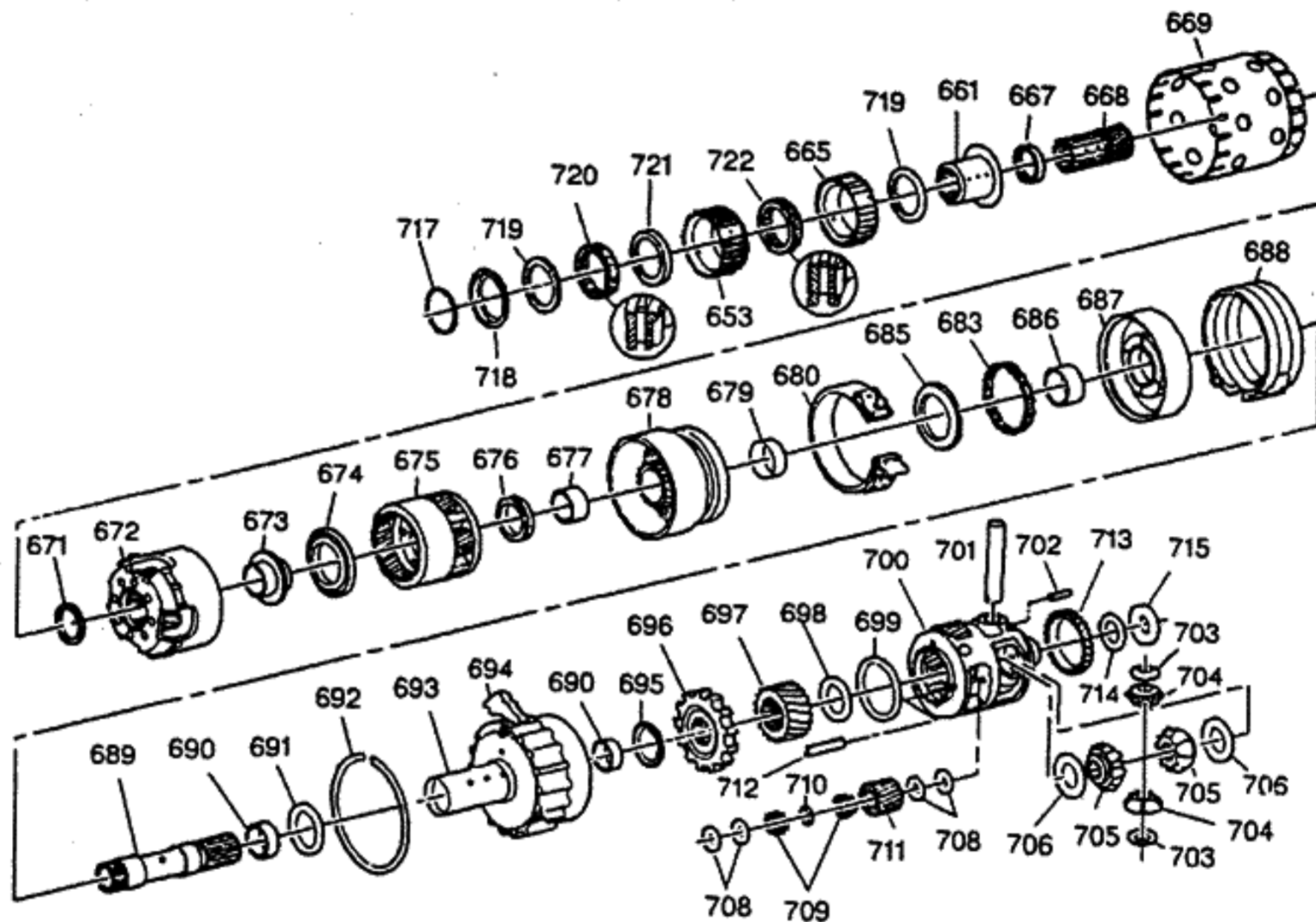

Supplies

(668) Input Sun Gear, P/N 24204098

- o (672) Input Complete Carrier Assembly, P/N 24204430
- o (674) Input/Reaction Carrier Thrust Bearing Assembly, P/N 24205127
- o (675) Reaction Complete Carrier Assembly, P/N 8646504
- o (676) Reaction Carrier/Sun Gear Thrust Bearing Assembly, P/N 8649353

4. Replace the parts listed above to correct this condition. Refer to Unit Repair Manual, Transmission Overhaul procedure, SI Document ID #417561; Input and Third Sprag Clutches Disassemble, SI Document ID #38901; and Input and Third Sprag Clutches Assemble, SI Document ID #60415.
5. When servicing or replacing the transaxle resulting from this condition, the transaxle cooler MUST be flushed. Refer to informational Corporate Bulletin #02-07-30-052.

Parts Information

Part Number	Description
24204098	Sun Gear (668)
24204430	Input Carrier (672)
24205127	Reaction Sun/Drum Gear Assembly (675)
8645504	Thrust Bearing (674)
8649353	Thrust Bearing (676)
24206433	Transaxle Filter
24206182	Gasket
8682442	Spacer
24206991	Gasket, Side Cover

Parts are currently available from GMSP0.

Warranty Information

For vehicles repaired under warranty, use:

Important:

- The recondition transaxle add time is not applicable for this repair. All of the transaxle clutch packs and bushings have not been replaced.
- The recondition transaxle Carrier/Differential Final Drive Assemble is not applicable for this repair.

Labor Operation	Description	Labor Time
K7552	Gear, Reaction Sun - R&R or Replace	Use Published Labor Time

